



**ZIMBALI**  
LAKES RESORT



**TECOMA VIEWS**

**CONTEMPORARY MODERN LIVING**





## CRAFTED FOR MODERN LIVING

Plans have been approved for the commencement of turn-key top structure lock-up-and-go free standing homes. These will mainly appeal to long term rental investors, young professionals and all families.

Tecoma Views will fully embrace the concept of creating a community where people can live, work, eat, exercise and socialise.

Zimbali Lakes is the paradigm of multi-generational living offering retirees, young professionals and families the opportunity to live the Zimbali lifestyle. The pet-friendly Zimbali Lakes Resort is a stylish assembly of some of the finest and most desirable amenities seen within a gated estate, offering unparalleled choice to residents at any stage of life.

Zimbali Lakes is the perfect choice in luxury estate living.



TYPE C ENTRANCE



# SITEPLAN





## UNIT TYPE A

### GROUND FLOOR

LIVING 101.0M<sup>2</sup>  
 COVERED PATIO 28.0M<sup>2</sup>  
 OPEN PATIO 10.0M<sup>2</sup>

### FIRST FLOOR

LIVING 78.0M<sup>2</sup>  
 GARAGE 38.5M<sup>2</sup>  
 COVERED PATIO 4.5M<sup>2</sup>

**TOTAL 260.0M<sup>2</sup>**

## GROUND FLOOR



## FIRST FLOOR



## UNIT TYPE B

### BASEMENT FLOOR

LIVING 31.0M<sup>2</sup>  
 GARAGE 58.0M<sup>2</sup>

### GROUND FLOOR

LIVING 79.0M<sup>2</sup>  
 COVERED PATIO 26.0M<sup>2</sup>

### FIRST FLOOR

LIVING 85.0M<sup>2</sup>  
 COVERED PATIO 3.0M<sup>2</sup>

**TOTAL 282.0M<sup>2</sup>**

## BASEMENT FLOOR



## GROUND FLOOR



## FIRST FLOOR



### UNIT TYPE C

**GROUND FLOOR**  
 LIVING 89.5M<sup>2</sup>  
 COVERED PATIO 50.8M<sup>2</sup>  
 GARAGE 40.9M<sup>2</sup>

**FIRST FLOOR**  
 LIVING 119.8M<sup>2</sup>  
 OPEN PATIO 29.0M<sup>2</sup>

**TOTAL 330.0M<sup>2</sup>**

### GROUND FLOOR



### FIRST FLOOR



### UNIT TYPE D

**GROUND FLOOR**  
 LIVING 130.0M<sup>2</sup>  
 COVERED PATIO 27.0M<sup>2</sup>

**FIRST FLOOR**  
 LIVING 123.0M<sup>2</sup>  
 GARAGE 41.5M<sup>2</sup>  
 COVERED PATIO 6.0M<sup>2</sup>

**TOTAL 327.5M<sup>2</sup>**

### GROUND FLOOR



### FIRST FLOOR

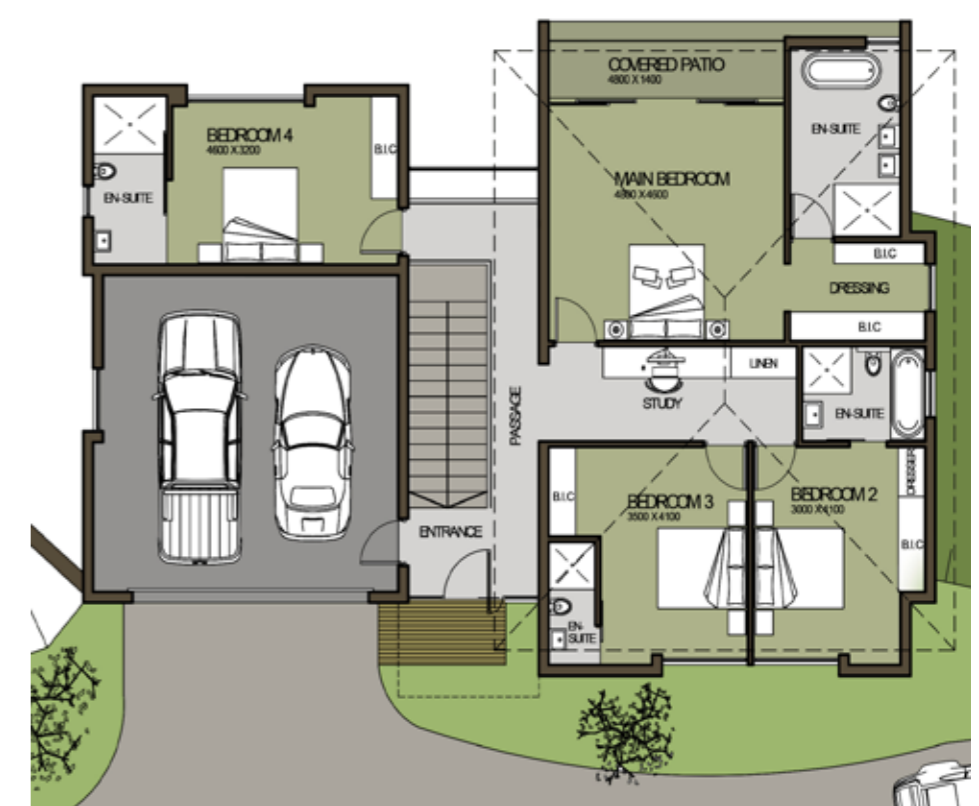



## RESIDENTS ENJOY DIRECT ACCESS TO A HOST OF PLANNED PREMIUM AMENITIES:

- State-of-the-art 24-hour security
- 18-hole golf course
- Kid's play area
- Gym and fitness facilities
- Zimbali Sports Club
- Zimbali Beach Club
- Zimbali Water Club
- Pristine beaches and swimming pools
- 20-hectare of lakes
- Walking paths, running and biking trails
- Bird hides and nature conservancy
- Retail outlets and convenience stores
- Restaurants and coffee shops
- Office space and commercial opportunities
- Fibre access to the home
- Pet-friendly estate



On-site Sales Centre  
Open Daily  
8:00 -17:00

087 095 2742  
hello@myzimbali.co.za  
zimbali.co.za



DEVELOPER

